

A spectacular space in Zaha Hadid's sweeping creation. This beautiful, ground floor space with high ceilings in the West 27th street frontage of Zaha Hadid's 520 West 28th Street building is perfect for a small gallery or art bookstore and café, and includes occasional access to the private 12-seat IMAX theater. Delivered with restroom and storage area.

It can be combined with two other gallery spaces to the east – ZH521 and ZH523 – and is adjacent to the Paul Kasmin Gallery on the west.

- 1,000 SF (93 m²) gallery | wine bar | bookstore | café
- Column-free space
- All glass frontage, Zaha designed façade
- Oversized doors with 15' ceilings
- Concrete floors and restroom
- Connects to West Chelsea's only private IMAX theater for occasional use
- Landlord contribution negotiable
- Could be combined with ZH521 next door
- Expected delivery in early Spring 2017

Call for pricing – 212.784.3507 ext 1731



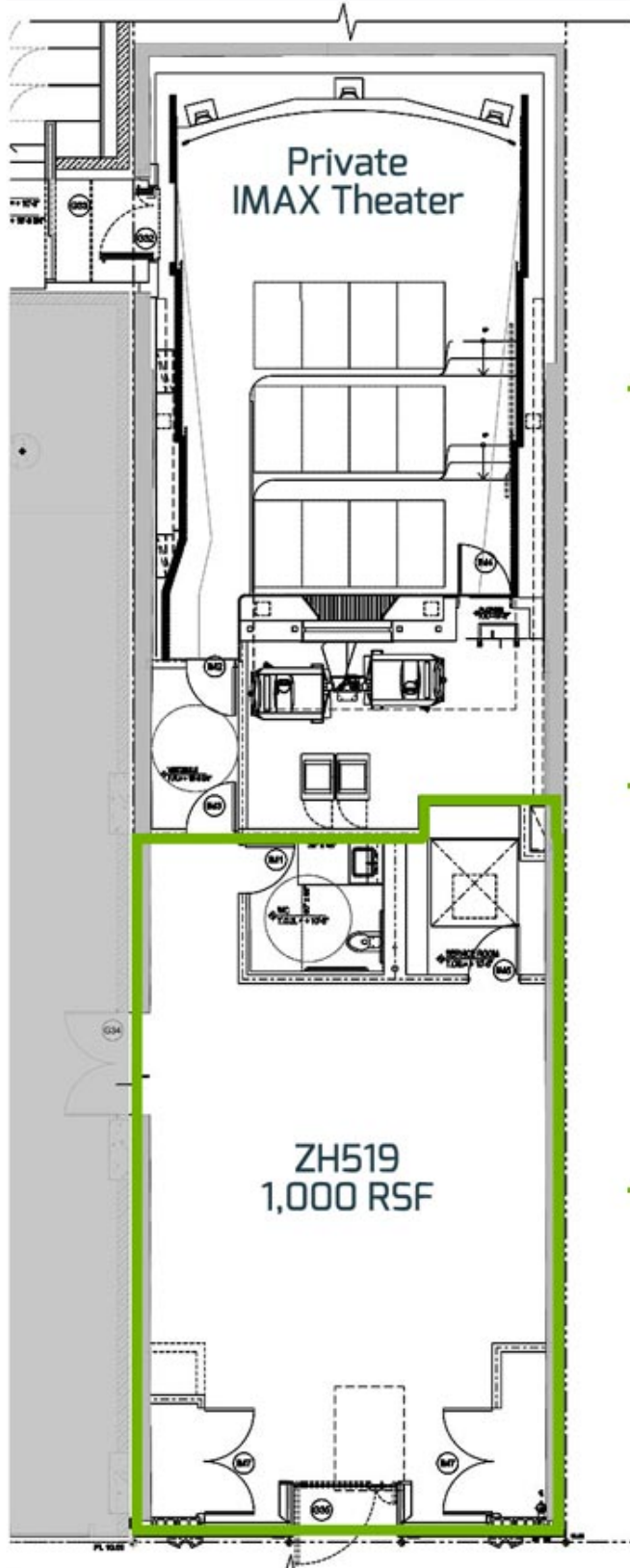

OPTION A

ZH523 • 2,510 RSF

ZH521 • 1,900 RSF

ZH519 • 1,000 RSF

includes restroom, storage and occasional use of IMAX theater

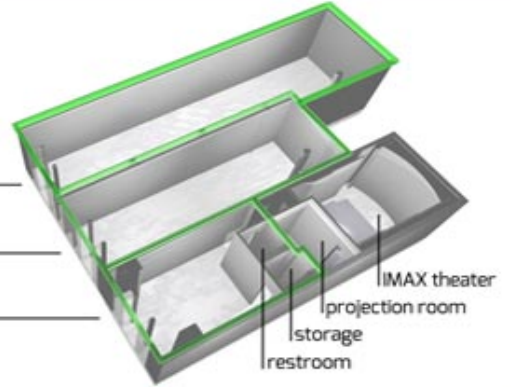

OPTION B

ZH521-523 • 4,410 RSF

ZH519 • 1,000 RSF

includes restroom, storage and occasional use of IMAX theater

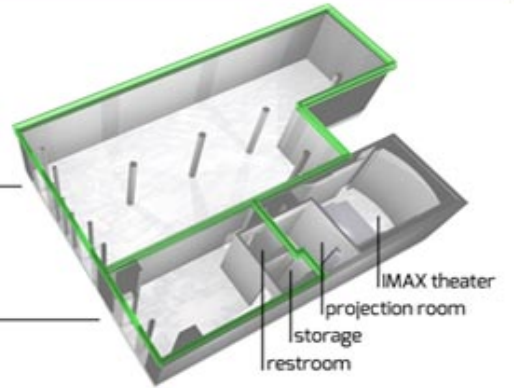

OPTION C

ZH523 • 2,510 RSF

ZH519-521 • 2,900 RSF

includes restroom, storage and occasional use of IMAX theater

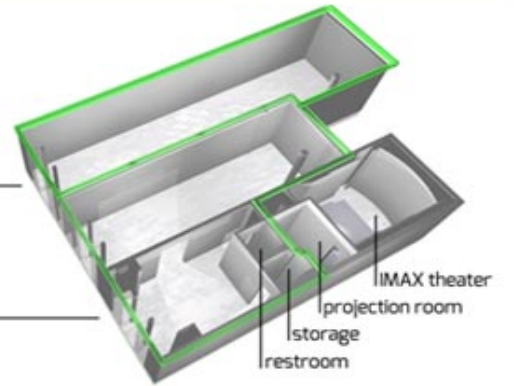

OPTION D

ZH519-523 • 5,410 RSF

includes restroom, storage and occasional use of IMAX theater

